

OWNER  
**RTS PROPERTIES**  
 900 3RD STREET  
 SAINT FALL PARK, MN.

# RTS PROPERTIES

## BUILDING CODE ANALYSIS

THIS IS AN EXISTING STRUCTURE WITH PLEASANT APPENDIX CHAPTER 91  
 OF THE 2014 MINNESOTA BUILDING CODE.

### BUILDING OCCUPANCY CLASSIFICATION

F-1 - SINGLE LEVEL BUILDING

### OCCUPANCY SEPARATION

F-1 AND E = 1 HOUR SEPARATION

### GROSS FLOOR AREA

FIRST FLOOR  
 F-1 OCCUPANCY = 29,492 SF. TOTAL GROSS

### BREAKDOWN OF SQUARE FOOTAGE

LEASEABLE S. F.	17,799 S.F.
MECH. ROOM S. F.	478 S.F.
STORAGE S. F.	205 S.F.
COMMON CORRIDORS S. F.	4,792 S.F.
SHARED TOILET ROOMS S. F.	278 S.F.
<b>TOTAL</b>	<b>29,492 S.F.</b>

### OCCUPANT LOAD

MANUFACTURING AREA = 50 SF. PER OCCUPANT  
 19,246 SQUARED FEET = 384.92 OCCUPANTS TOTAL

### EXIT REQUIREMENTS

TOTAL WIDTH OF EXITS IN BLDG. 87' X 2 = 174 INCHES REQUIRED MIN.

TRAVEL DISTANCE: THE MAXIMUM TRAVEL DISTANCE OF 100 FEET MAY BE INCREASED UP TO AN  
 ADDITIONAL 50 FEET WHEN TRAVEL DISTANCE OCCURS IN THE LAST PORTION  
 OF THE TRAVEL DISTANCE AND IS ENTIRELY WITHIN A ONE HOUR FIRE RESISTIVE WALL.

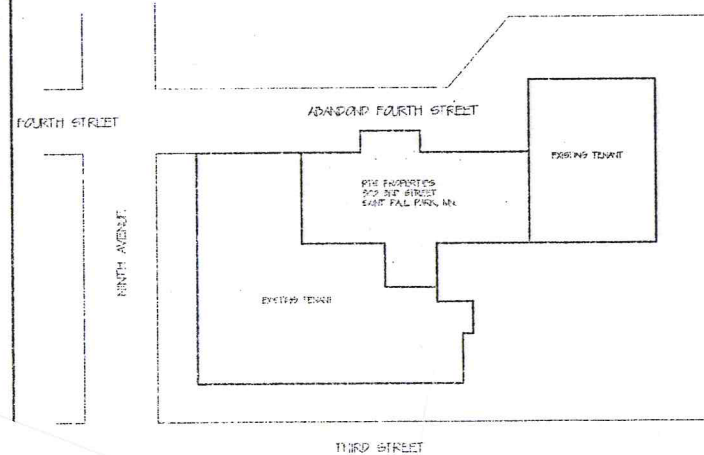

LOCATION MAP

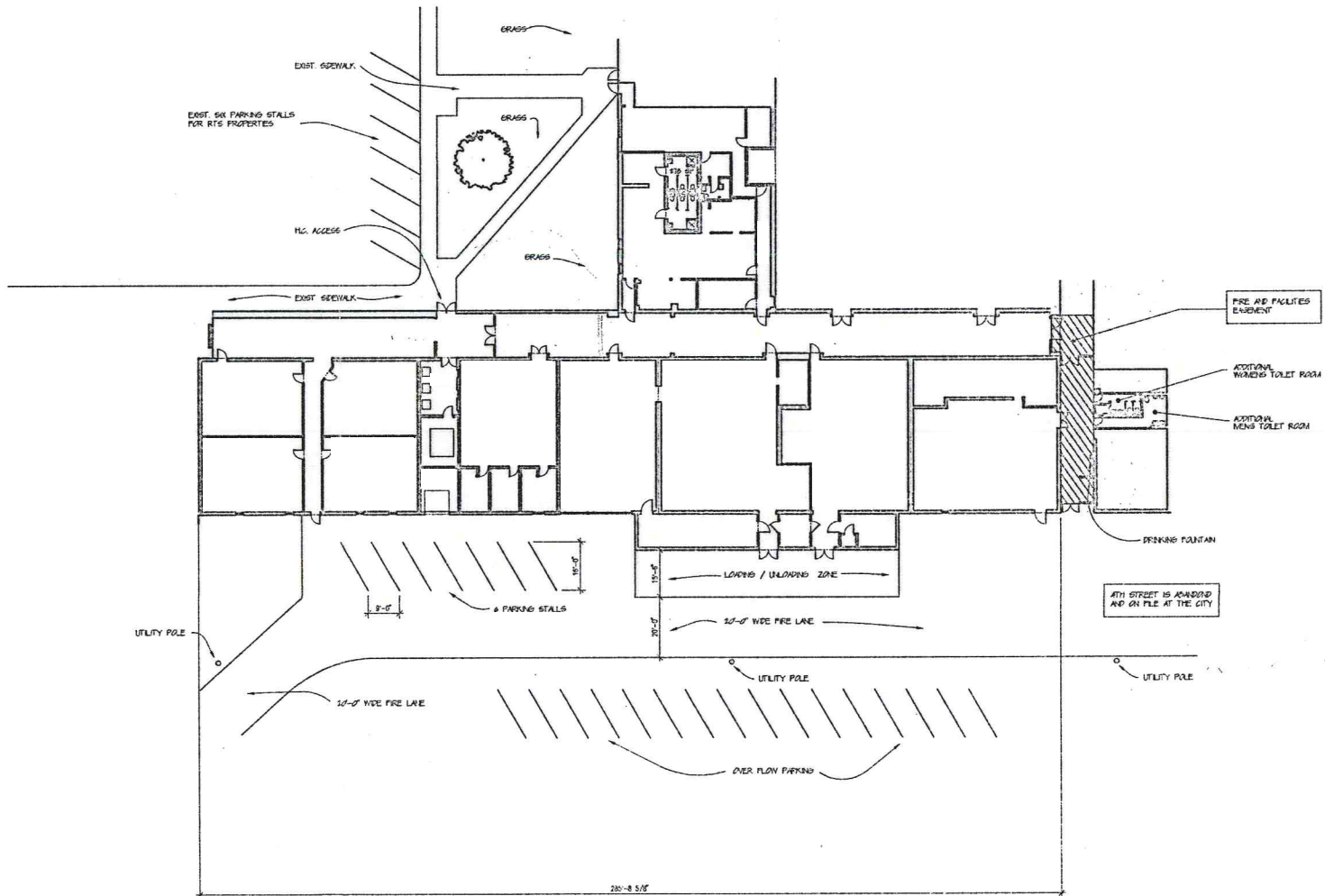

## SITE PLAN

SCALE 1/4" = 1'-0"



LEASEABLE S. F.	17,799 S.F.
MECH. ROOM S. F.	478 S.F.
STORAGE S. F.	205 S.F.
COMMON CORRIDORS S. F.	4,792 S.F.
SHARED TOILET ROOMS S. F.	278 S.F.
<b>TOTAL</b>	<b>29,492 S.F.</b>

## PLANS

DATE: 08/14/2014  
 TIME: 10:00 AM  
 SHEET: A-1

### ARCHITECT

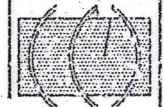

PORTLAND STRUCTURAL  
 ARCHITECTS, INC.  
 6300 Broadway Dr.  
 Saint Paul, MN 55125  
 651.234.3333

RTS PROPERTIES  
 ST. PAUL PARK, MN

DATE: 08/14/2014

## SITE PLAN

Sheet number: A-1